

Contact

SOUDAL NZ LTD

134 Kohia Drive, Horotiu, 3288

Hamilton, New Zealand

Ph: 0800 70 10 80

Email: sales@soudal.co.nz

www.soudal.co.nz



Post Kit

Retracting Clothesline

99157578 & 99157387



Introduction

Congratulations

Congratulations on the purchase of your Sun King Retracting Clothesline Post Kit, which will bring you many years of trouble free and efficient drying. It's important that you read this Product Manual thoroughly before installation to benefit from the design features and enjoy safe use of this product. Thank you for choosing Sun King.

Note: If you are mounting a Sun King Retracting Clothesline to your Post Kit, you will require a Mount Bar, sold separately:

- **Mount Bar 4 - Item Code 99157363 & 99157554.**
- **Mount Bar 6 - Item Code 99157370 & 99157561.**

Note: All fasteners required for assembling the Sun King Retracting Clothesline to the Mount Bar are supplied with the Mount Bar.

Warning

- Do not allow children or pets to swing on the Clothesline or items of laundry.
- Do not use for any purpose other than to hang and dry washing.
- Do not use your Clothesline if parts are worn or damaged.
- Do not operate the locking lever when the arm is located in the cabinet.
- Do not release the locking mechanism when there are clothes attached to the lines.
- Do not allow the arm and lines to retract uncontrolled as this may lead to personal injury or property damage. Hold the arm securely and walk it back to the cabinet.

Warranty

In addition to all rights and remedies to which you may be entitled under the New Zealand Consumer Guarantees Act (1993) and any other relevant legislation, Soudal NZ Limited warrants the product to be free from defects in materials or workmanship for 10 years from the date of purchase.

In the event of a claim, you must take the product with proof of purchase and an explanation of the fault to the place of purchase or contact Soudal NZ Limited and provide your proof of purchase. All costs associated with the return of the good (and other expenses incurred in claiming under this warranty) are your responsibility. We will, at our option, either repair or replace the product if it has a defect in its materials or workmanship.

Soudal NZ Limited liability under this warranty is subject to Soudal NZ Limited being satisfied that a defect was caused by defective workmanship or materials and was not caused by or substantially contributed to by other factors including (but not limited to) maintenance or repair, adjustments or modifications of the product in a manner not recommended by the manufacturers or any neglect, misuse or excessive use. For the avoidance of doubt, this warranty does not cover acts of God, earthquake, cyclone, fire, explosion, flood, landslide, lightning, storm, tempest, drought or meteor, war, terrorism, restraint or damage to property by or under the order of any government authority or industrial action.

You are entitled to a replacement or refund for a major failure and for compensation for any other reasonably foreseeable loss or damage. You are also entitled to have the goods repaired or replaced if the goods fail to be of acceptable quality and the failure does not amount to a major failure.

For goods purchased within New Zealand, this warranty is provided by Soudal NZ Limited, 134 Kohia Drive, Horotiu, Hamilton. Phone 0800 70 10 80.

Final Assembly

Note: Please refer to the Retracting Clothesline Mount Bar Manual if you are installing your Retracting Clothesline Cabinet to a Post Kit.

1.1 After allowing 48 hours for the concrete to set, use the two M8x70 socket head bolts, two M8 nuts and four M8 washers to attach the Receiving Bracket (Included with Retracting Clothesline) to the desired height on the Post Assembly. **(Fig 2).**

Fig. 2

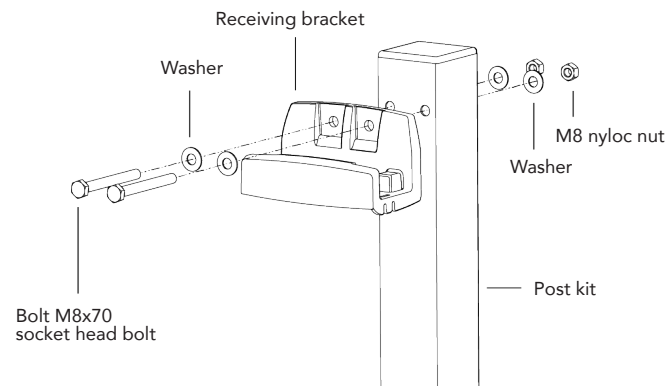

3.1 Your Post Kit has three height positions for a total of 236mm adjustment. To adjust the height of the Top Post, remove bolts, washers and nuts and move to new position. Re-secure bolts, washers and nuts. **(Fig 3).**

Fig. 3

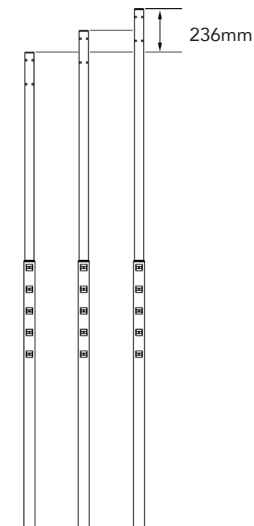

Package Contents

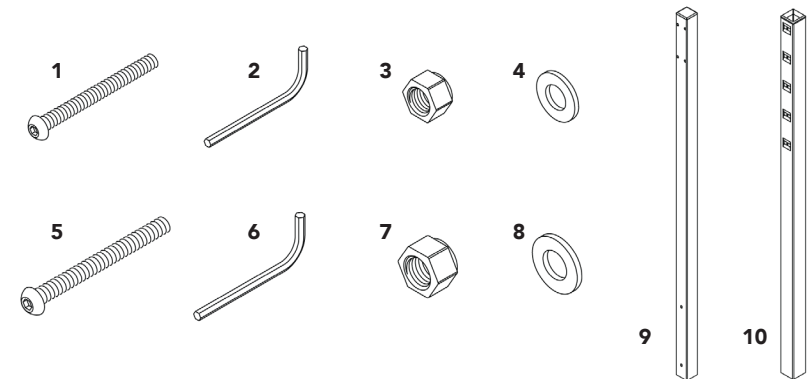

Retracting Clothesline Post Kit

Item	Part Name	Quantity
1	Socket head bolts M6x65	2
2	Hex key 4mm	1
3	Nyloc nuts M6	2
4	Washers M6	4
5	Socket head bolts M8x70	2
6	Hex key 5mm	1
7	Nyloc nuts M8	2
8	Washers M8	4
9	Top post	1
10	Bottom post	1

***Required materials and tools (Not Included)**

- Pre-mix concrete
- Coarse gravel
- Tape measure
- Spirit level
- Spade

Installation Instructions

Installing directly into concrete

- 1.1 Assemble your Post Kit by inserting the Top Post into the Bottom Post and secure with M6x65 bolts, nuts and washers.
- 1.2 Mark out the desired position for the Post Kit in line with the Retracting Clothesline Cabinet - Please refer to your Retracting Clothesline product manual for site selection and installation details.
- 1.3 Dig a hole 200mm in diameter x 650mm deep. Place approximately 200mm of coarse gravel in the bottom of the hole. Insert the Post Kit into the ground and push the post 50mm into the coarse gravel. (Fig 1).

Fig. 1

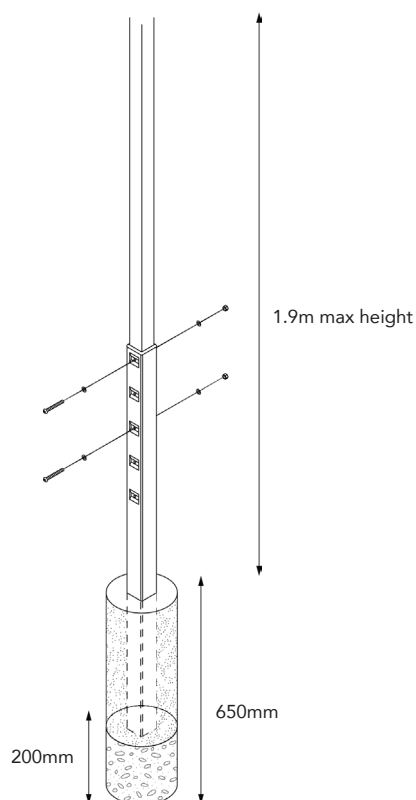

- 1.4 Adjust the Post Kit until the desired height is achieved. The top of the Top Post should be 115mm above user head height.

Note: If installing both the Cabinet and Receiving Bracket to posts, ensure that the holes in the Bottom Post are parallel with the line between the two Post locations (See Step 1.2). If posts aren't correctly aligned, the lines of the Sun King Retracting Clothesline will not be consistently tensioned once installed.

- 1.5 Concrete should be damp enough to hold together when squeezed in your hand. Support the Post Assembly in position and fill the hole with concrete. Settle the concrete by pushing a thin stick into the mix several times.
- 1.6 Use a spirit level to check the Post Assembly is vertical. Slope the surface of the concrete away from the Post Assembly to provide drainage.

Note: Allow 48 hours for the concrete to set before use.

