

Details on Fire Penetrations and Gorilla Products

Fire related products and where they can be used:

Due to an update interpretation of the NZBC regarding the specification certification of Fire Rated jointing and penetrations you need to pass in the following:

- All Fire Rated Linier Joint design is covered by the requirements of AS1530.4
- All Fire Rated Penetration design is covered by the requirements of AS4072.1
- Soudal Fire Rated Product family includes the following items:

Product Code	Product Description
20160	Gorilla Fire Rated Expanding Foam Click & Fix 750ml
20169	Gorilla Fire Rated Expanding Foam Aerosol 750ml
20060	Gorilla Firecryn Fire Rated Sealant 310ml White
21427	Gorilla Firecryn Fire Rated Sealant 600ml Grey
56219	Gorilla Firestop MS

The following **Linier Joint Design** (horizontal & vertical) are covered by the Soudal Fire Rated Product Certifications:

- Linier Joints are covered off between 10mm – 40mm. This covers both internal and external located joints in walls and between walls and ceilings.
- Please check the appropriate Fire Report for specific details
- Depending on report the Soudal products have been tested on concrete and aerated concrete

Soudal Products tested are:

- **Gorilla Expanding Foam FR**
- **Gorilla Firecryn**
- **Gorilla Firestop MS**
- **Gorilla Firecryn**



The following **Penetration Joint Design** are covered by the Soudal Fire Rated Product Certificates **up to 60 minutes**

Pipe Penetration

Steep Pipe up to 150mmOD, up to 186mm Diameter Thru Hole, Steel Sleeve used, products used in test with "Plasterboard wall structure"

- **Gorilla Expanding Foam Fire Rated**
- **Gorilla Firecyl**

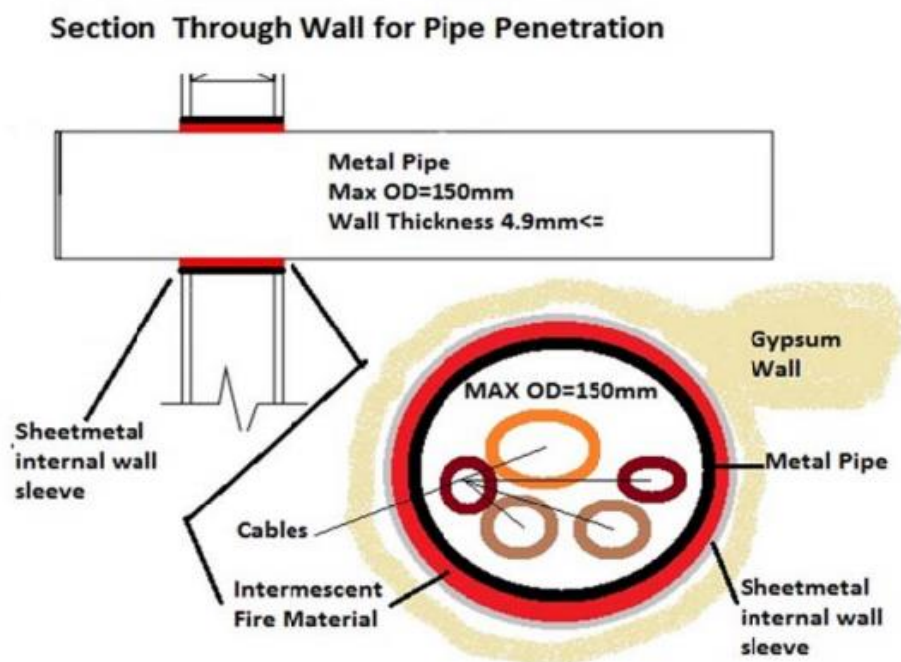

**UP TO
60 minutes
Integrity**

Cable Penetration

Cable sizes tested

- Single Cable, 34mm OD
- Single Cable, 65mm OD
- Three Cables, 14mm OD
- Three Cables, 18mm OD

Steel Cable tray used with Steel Over Flashing

Products used in test with "Plasterboard wall structure"

- **Gorilla Expanding Foam Fire Rated**
- **Gorilla Firecryn**

Cable Tray Penetration through Gypsum Wall

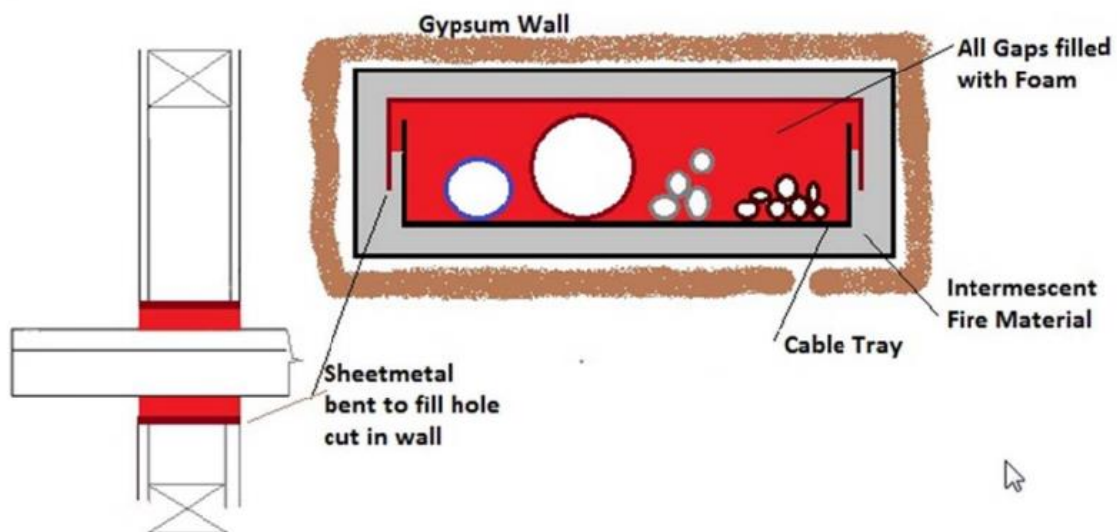

For further information please contact info@soudal.co.nz or 0800 70 10 80